

Impact of AT&T 2G Shutdown on the Carlson BRx5 GNSS receiver

On Dec 31, 2016, AT&T ceased providing 2G service on the AT&T cell network. Because of this shutdown, the internal cell modem in the Carlson BRx5 GNSS receiver no longer works on the AT&T cell network. All other Carlson products with internal cell modems (BRx6 GNSS receiver, Mini2 (Geo/Cell model), Surveyor2 (Geo/Cell and Cell models) and RT3 data collectors) continue to work on the AT&T cellular network.

The following options are available for connecting the BRx5 GNSS receiver to a reference network using a cell modem:

1. Use a MiFi device or a smartphone as a WiFi access point for cellular data and operate SurvCE in Data Collector Internet mode. If you were pleased with the cellular coverage in your work areas using the AT&T network, this may be the most practical solution. It may require purchasing a AT&T compatible mobile access point (MiFi type device).
2. If your data collector has an internal 3G cell modem, you can continue using your AT&T SIM card in the data collector and operate SurvCE in the Data Collector Internet mode. If you are using a Carlson Mini2 or Carlson Surveyor2 data collector, you can look at the home screen to determine if your model includes a cell modem. If the home screen has a 3G Modem icon (see icon circled in red to the right), the Carlson data collector contains an internal cell modem and works on the AT&T network.

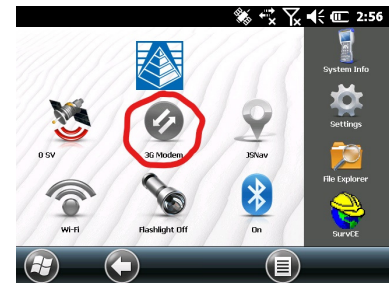

3. T-Mobile cell network will support 2G GSM network until 2020. T-Mobile SIM cards configured for Tablets/MI (mobile internet) devices, not phones, have been tested on the BRx5 and are fully functional.
 - If you purchase a T-Mobile SIM card and data plan, be sure to request a SIM card configured for tablets (also called MI configuration). SIM cards configured for phones will not work properly on the BRx5.
 - T-Mobile 2G coverage may not be as extensive as AT&T coverage was. We recommend that you confirm coverage in your projected work areas before purchasing T-Mobile SIM cards.
 - StraightTalk Wireless also provides access to the T-Mobile and may have a more flexible or lower cost data plan. Carlson has successfully used StraightTalk Wireless SIM cards in the BRx5. If you want to use StraightTalk Wireless, select the BYOT (Bring Your Tablet option). StraightTalk Wireless provides nano SIM cards with a full size plastic adapter that will work in the BRx5. If you move your SIM card between devices, a nano SIM card with adapter is not a good choice. The nano SIM easily falls out of the adapter and can be lost when move from device to device.
 - There may be other suppliers of 2G GSM cellular access, but Carlson has not tested any other providers.

As mentioned earlier, the Carlson Mini2, Surveyor2, and RT3 data collectors (Cell and Geo/Cell models) and the Carlson BRx6 GNSS receivers are fully functional on the current AT&T network using AT&T SIM cards.

This update was released on Monday, January 16, 2017 at 9:00AM Eastern.